

## Pricing and Reservations

**PRICING:** Lodging prices vary due to type of facility; number of guests the facility accommodates; Pennsylvania residency status; length of stay; day of the week; and season.

For base pricing information, scan the code or visit the Pennsylvania state parks website at <http://www.dcnr.pa.gov/StateParks/StateParkPrices>

Please note, base pricing information does not include fees or taxes.

**RESERVATIONS:** Lodging in Pennsylvania state parks can be reserved 11 months to three days before the day of arrival. If it is two days or less before the arrival date, call the state park to inquire about availability.

For reservations, call the Pennsylvania State Parks Reservation Center at 888-PA-PARKS (888-727-2757), Monday through Saturday, 7:00 AM to 5:00 PM, or visit <http://pennsylvaniastateparks.reserveamerica.com>.

Reservations can be made using MasterCard, VISA, American Express, and Discover credit cards; personal, traveler's, and cashier's checks; or a Pennsylvania State Parks Gift Card. To receive a confirmed reservation, full payment must be received within ten days of making the reservation.

**FEES:** A non-refundable transaction fee is charged for each reservation.

Cabin, lodge, unique house, and inn prices incur additional state and/or county local tax(es). The county local hotel occupancy tax rate varies depending on the location in the Commonwealth.

Designated dog-friendly facilities charge an additional fee per night.

**CANCELLATIONS AND CHANGES:** Cancellations, changes, or transfers to reservations will be assessed a fee and can be made prior to arrival by the Pennsylvania State Parks Reservation Center.

Any cancellation, change, or transfer made upon arrival must be processed through the state park. For complete information on fees, cancellations, changes, transfers, and discount policies, view the Reservation Cancellation/Change Policy at the website in the "Reservations" section above.



## Black Moshannon State Park

Black Moshannon State Park covers 3,394 acres of forests and wetlands and conserves unique, natural environments. More than 43,000 acres of the Moshannon State Forest surround the park and help create a remote and wild setting that provides recreational opportunities in all seasons.



The park is known for spectacular bogs, marshes, and swamps. Discover wetlands by walking the Bog and Moss-Hanne trails. Look for carnivorous plants, such as pitcher plant and sundew, other unusual wildflowers, and colorful damselflies and dragonflies. Sharp-eyed visitors may encounter frogs, salamanders, northern water snakes, or black bears. Many birds make their summer homes only in wetland habitats making the park a great place for birdwatching.

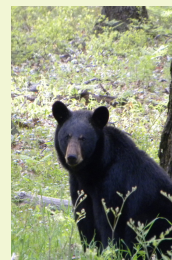

### Access for People with Disabilities

This publication text is available in alternative formats. If you need an accommodation to participate in park activities due to a disability, please contact the park you plan to visit.

## Lodging

### Black Moshannon State Park



Modern Cabin

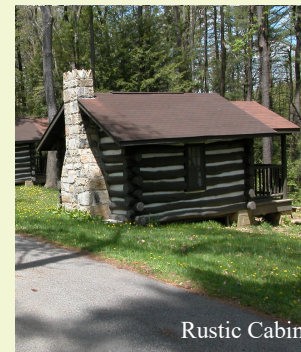

Rustic Cabin



Deluxe Cottage

4216 Beaver Road  
Philipsburg, PA 16866  
GPS DD: Lat. 40.91312 Long. -78.06469  
814-342-5960  
[BlackMoshannonSP@pa.gov](mailto:BlackMoshannonSP@pa.gov)

### Reservations:

888-PA-PARKS  
[www.dcnr.pa.gov/StateParks](http://www.dcnr.pa.gov/StateParks)

## Black Moshannon State Park Lodging

The cabin area has modern cabins and a rustic cabin (cabin 14) open year round. Rustic cabins 1-12 and deluxe cottages are open from mid-April to mid-December. A playground, laundry facility, restrooms, and warm showers are in the cabin area. All cabins and deluxe cottages have lights, outlets, electric heat, porch, picnic table, and fire ring.

Rustic cabins 1-6 have one room and sleep four guests in two sets of single bunk beds. Rustic cabins 7-12 and 14 have a dining room and a separate bedroom that sleeps six in one set of single bunk beds and one set of double bunk beds. All rustic cabins have a table and chairs, stove/oven, microwave, refrigerator, electric heat, and a wood-burning stove. Rustic cabins do not have running water. Cabin 14 also has air conditioning.

Deluxe cottages 21 and 22 have a dining room with a dining table and chairs, stovetop, refrigerator, and microwave; and a separate bedroom that sleeps five guests in a set of single bunk beds and a set of double/single bunk beds. Deluxe cottages do not have running water.

Modern cabins 13 and 15-19 have a living area (couch, chairs, end tables, lamps); kitchen with stove/oven, refrigerator, microwave, sink, coffee pot, table and chairs; bathroom (shower, sink, toilet); and sleep six in two bedrooms, one with a double bed (queen bed in cabin 13) and one with two sets of single bunk beds. Cabin 13 also has a grill and wood burning stove. All modern cabins have electric heat and air conditioning.

**WHAT TO BRING:** Guests should bring bedding, pillows, towels, etc.; all cooking, serving, and eating utensils; coffee pot; toaster; toiletries; soap; containers to carry water; and dishpans. Tents, camping trailers, and RVs are prohibited.

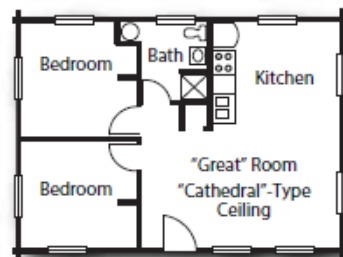

2-bedroom Modern Cabin Floor Plan

## Black Moshannon State Park Lodging Map

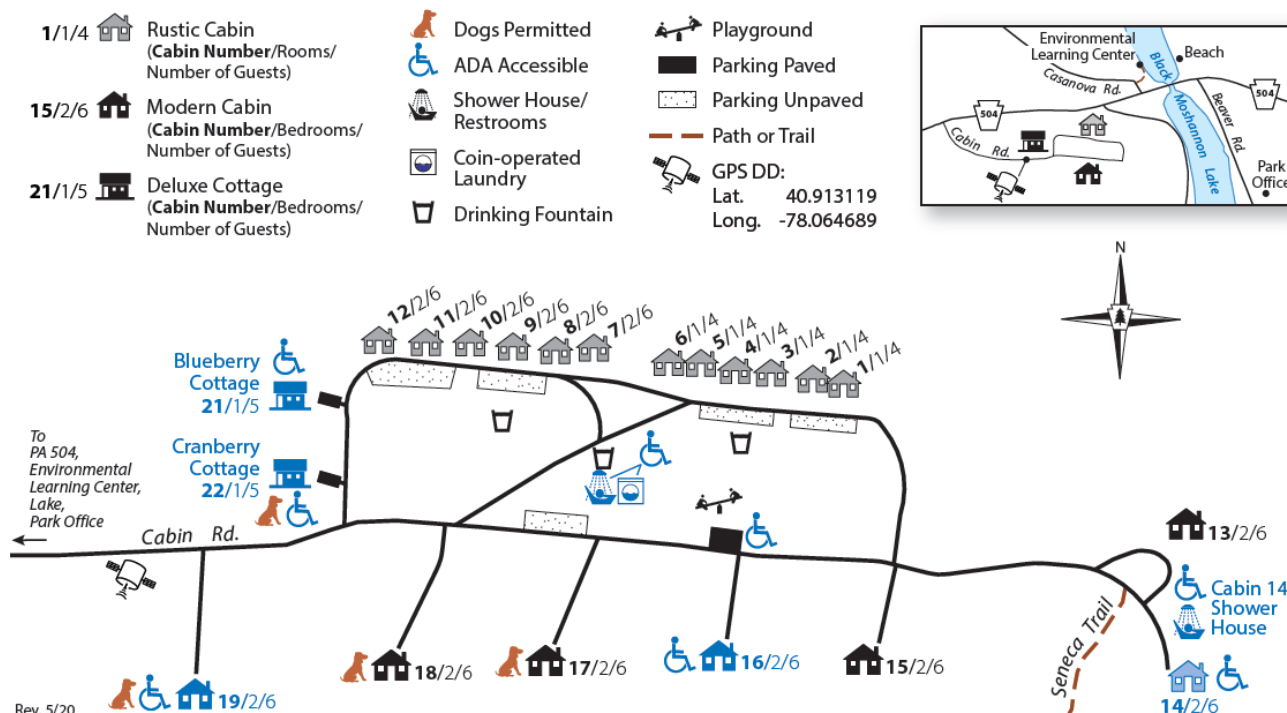

Rev. 5/20

## Lodging Rules

**CHECK-IN:** Check-in time is 3:00 PM at the park office. If arriving after hours, please pick up your key inside the park office vestibule on the left-hand side.

**CHECK-OUT:** Lodging must be vacated by 10:00 AM. After cleaning the facility, disposing of trash, and removing personal property, return keys and lodging survey to the park office. If the office is closed, deposit keys and paperwork in the box in the park office vestibule.

**ALCOHOLIC BEVERAGES:** Alcoholic beverages are prohibited in all Pennsylvania state parks.

**PETS:** Up to two dogs are permitted at designated facilities for a fee. Pets are prohibited in swimming areas, buildings, and all overnight facilities not participating in the pet program.

Guide dogs and service dogs are not considered pets.

**FIRES:** Fires are only permitted in fire rings, grills, and fireplaces. Fires must be attended at all times and extinguished before leaving the area.

Firewood is not provided. Cutting live or standing trees and the operation of chainsaws are prohibited.

**QUIET HOURS:** Campers must not disturb the sleep of others between 9:00 PM and 8:00 AM.

**VISITORS:** Visitors are welcome from 8:00 AM to 10:00 PM.

**MINIMUM/MAXIMUM STAY:** Deluxe cottages and cabins have a two-night minimum and a 14-night maximum stay in the non-peak season. In the summer peak season, the second Friday in June to the third Friday in August, rentals are weekly (Friday to Friday).

**HUNTING:** Use extreme caution with firearms at all times. Other visitors use the park during hunting seasons. Firearms and archery equipment used for hunting may be uncased and ready for use only in authorized hunting areas during hunting seasons. In areas not open to hunting or during non-hunting seasons, firearms and archery equipment shall be kept in the owner's vehicle or enclosed trailer. Exceptions include: law enforcement officers and individuals with a valid *Pennsylvania License to Carry Firearms* are authorized to carry a firearm concealed on their person while they are within a state park.