

Pricing and Reservations

PRICING: Lodging prices vary due to type of facility; number of guests the facility accommodates; Pennsylvania residency status; length of stay; day of the week; and season.



For base pricing information, scan the code or visit the Pennsylvania state parks website at <http://www.dcnr.pa.gov/StateParks/StateParkPrices>

Please note, base pricing information does not include fees or taxes.

RESERVATIONS: Lodging in Pennsylvania state parks can be reserved 11 months to three days before the day of arrival. If it is two days or less before the arrival date, call the state park to inquire about availability.

For reservations, call the Pennsylvania State Parks Reservation Center at 888-PA-PARKS (888-727-2757), Monday through Saturday, 7:00 AM to 5:00 PM, or visit <http://pennsylvaniastateparks.reserveamerica.com>.

Reservations can be made using MasterCard, VISA, American Express, and Discover credit cards; personal, traveler's, and cashier's checks; or a Pennsylvania State Parks Gift Card. To receive a confirmed reservation, full payment must be received within ten days of making the reservation.

FEES: A non-refundable transaction fee is charged for each reservation.

Cabin, lodge, unique house, and inn prices incur additional state and/or county local tax(es). The county local hotel occupancy tax rate varies depending on the location in the Commonwealth.

Designated dog-friendly facilities charge an additional fee per night.

MINIMUM/MAXIMUM STAY: Modern cabins have a two-night minimum and a 14-night maximum stay in the non-peak season. In the summer peak season, the second Friday in June to the third Friday in August, rentals are weekly (Friday to Friday).

CANCELLATIONS AND CHANGES: Cancellations, changes, or transfers to reservations will be assessed a fee and can be made prior to arrival by the Pennsylvania State Parks Reservation Center.

Any cancellation, change, or transfer made upon arrival must be processed through the state park. For complete information on fees, cancellations, changes, transfers, and discount policies, view the Reservation Cancellation/Change Policy at the website in the "Reservations" section above.

Lodging Rules

CHECK-IN: Check-in time is 3:00 PM. During summer peak season, Jamestown Cabin key pick up is at the park office. For all other cabins and at all non-peak times, renters should go directly to the cabin.

CHECK-OUT: Cabins must be vacated by 10:00 AM. After cleaning the facility, disposing of trash, removing personal property, and locking the cabin, return the key to the park office for Jamestown Cabins during the summer peak season. For all other cabins and at all non-peak times, renters should leave the key in the cabin with the door unlocked.

ALCOHOLIC BEVERAGES: Alcoholic beverages are prohibited in all Pennsylvania state parks.

PETS: Pets are permitted in designated facilities for a fee. Pets are prohibited in swimming areas, buildings, and all overnight facilities not participating in the pet program.

Guide dogs and service dogs are not considered pets.

MOTOR VEHICLES: Park only in designated parking areas. Two vehicles are permitted at each six-guest cabin and three vehicles at each eight-guest cabin. Additional vehicles can park in the extra vehicle parking area at no charge.

FIRE: Fires are only permitted in fire rings and grills. Fires must be attended at all times and extinguished before leaving the area.

Firewood is not provided. Cutting live or standing trees and the operation of chainsaws are prohibited.

QUIET HOURS: Campers must not disturb the sleep of others between 9:00 PM and 8:00 AM.

HUNTING: Use extreme caution with firearms at all times. Other visitors use the park during hunting seasons. Firearms and archery equipment used for hunting may be uncased and ready for use only in authorized hunting areas during hunting seasons. In areas not open to hunting or during non-hunting seasons, firearms and archery equipment shall be kept in the owner's vehicle or enclosed trailer. Exceptions include: law enforcement officers and individuals with a valid *Pennsylvania License to Carry Firearms* are authorized to carry a firearm concealed on their person while they are within a state park.



Access for People with Disabilities

This publication text is available in alternative formats. If you need an accommodation to participate in park activities due to a disability, please contact the park you plan to visit.

1/2022



pennsylvania
DEPARTMENT OF CONSERVATION
AND NATURAL RESOURCES

Modern Cabins

Pymatuning State Park



Jamestown Cabin 15



Linesville Cabin 21

Park Office:

2660 Williamsfield Road
Jamestown, PA 16134
724-932-3142
PymatuningSP@pa.gov

Jamestown GPS DD: Lat. 41.51712 Long. -80.500
Linesville GPS DD: Lat. 41.6609 Long. -80.4642

Reservations:

888-PA-PARKS
www.dcnr.pa.gov/StateParks

Linesville and Jamestown Cabin

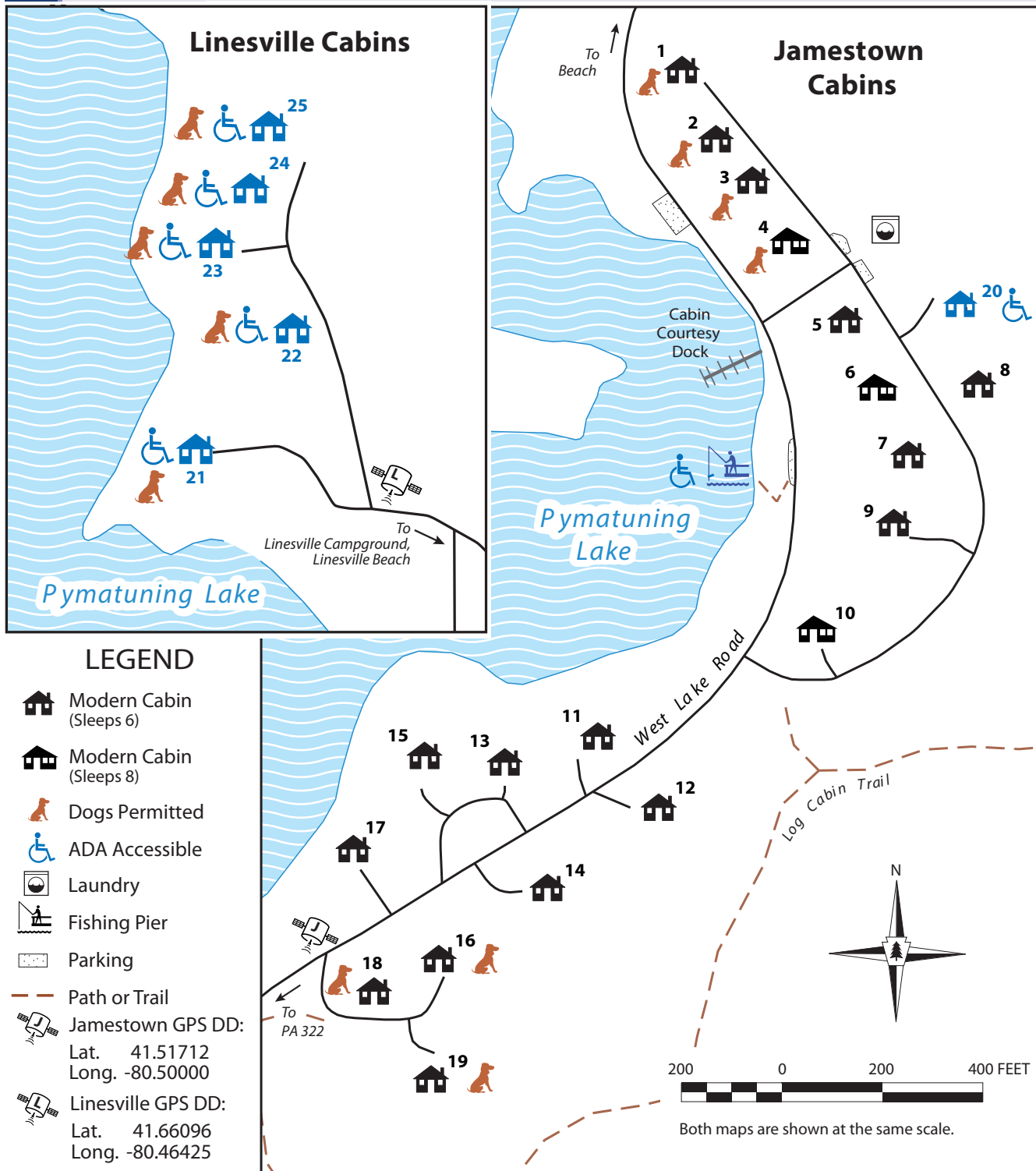

Cabin Information

Between the Linesville and Jamestown areas, there are 25 modern cabins available for rent year round. Cabins sleep six in two bedrooms, or sleep eight in three bedrooms. One bedroom has a queen bed and additional bedrooms have single bunk beds, except for cabins 20-25 which have a queen bed, double bed, and a single bunk beds. Each cabin features a living room (couch, chair, end tables, and lamps), a kitchen (dining table, sink, refrigerator, stove/oven, coffee pot, and microwave), a bathroom (shower, toilet, and sink), as well as an outdoor fire ring and picnic table. All cabins have electric heat and outlets. Designated cabins allow up to two dogs for an additional fee. Cabins 20-25 are ADA accessible. Cabins do not have a dishwasher, toaster, television, WiFi, or air conditioning.

A boat dock, fishing pier, and coin-operated laundry are in the Jamestown cabin area for guests. Cabin guests may also use the campground boat launch and fish cleaning station. Linesville cabin renters may pull boats on shore near their cabin.

WHAT TO BRING: All linens including sheets, blankets or sleeping bags, pillows, towels, etc.; all cooking, serving, and eating utensils; toiletries; and coffee filters.

Tents, camping trailers, RVs, and ATVs are prohibited.

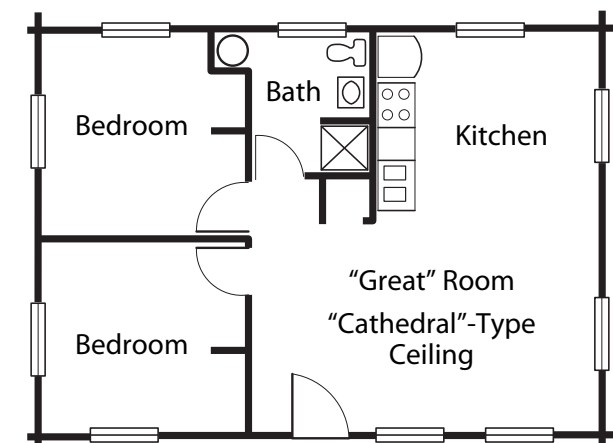

Six Guest Modern Cabin Floor Plan